

# Essex County Council & Great Bardfield Primary School

## What

The Public Consultation is taking place to share, proposed plans for replacing the relocatable classroom facilities at Great Bardfield Primary School, with the local community. It is your chance to review and comment upon the proposals before a planning application is submitted.

## Why

The new teaching block at Great Bardfield Primary School aims to create a modern energy efficient, educational building on the existing school site, which will replace existing relocatable classrooms that are now beyond their serviceable life.

The new accommodation will provide a Reception classroom and 2 Infant classrooms, both with stores, cloak and WC's to serve each. Externally, a level access will be provided and a canopy and outdoor play area at the rear of the building. There will also be landscaping to form an outdoor teaching and play space.

The Project will be designed to deliver a low carbon energy footprint during Construction and in use. This will include renewable energy through roof mounted photovoltaic solar panels and highly efficient air source heat pumps, generating heating and hot water, full fresh air through highly efficient mechanical heat recovery and efficient LED lighting, which better represents natural daylighting. The building fabric will also be thermally enhanced. The new building will offer a more inclusive educational environment for the pupils.

## Where is it

The Proposed new development will be situated at the rear of the site.

## When

The building will be finished and ready for occupation in December 2021. Work is planned to commence over the summer holidays. One of the existing temporary class room buildings will continue to provide accommodation during construction, with two additional temporary classroom on the playground. After the new building has been completed, these three buildings will be removed, the two existing storage containers will be retained and relocated on site.

## Who

The Project Partners are:

- Essex County Council
- Great Bardfield Primary School

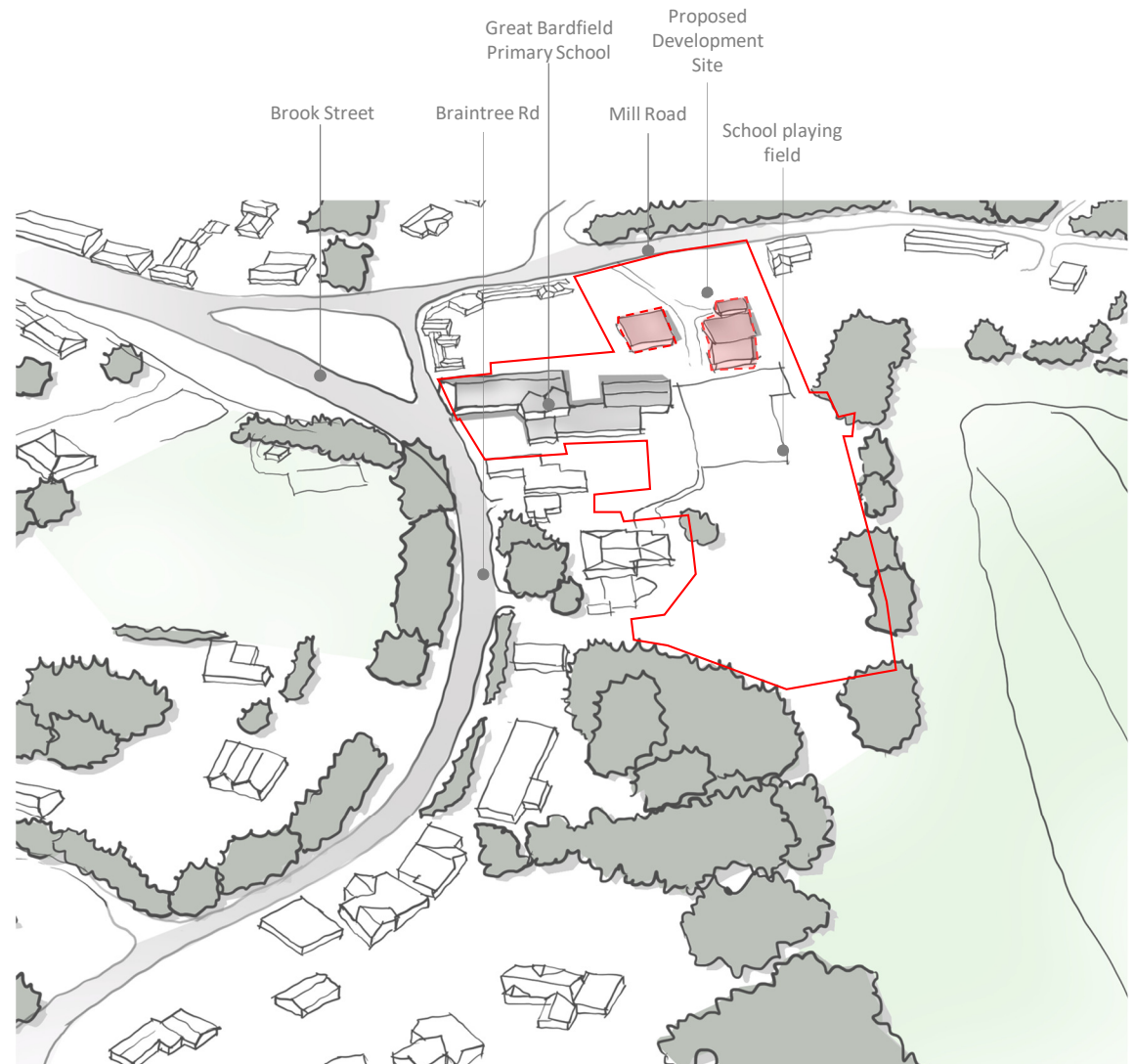

 Buildings to be removed

## Have Your Say

To comment on these proposals go to: <https://consultations.essex.gov.uk/infrastructure-delivery/consultation-for-great-bardfield-primary-school>

## Have Your Say

To comment on these proposals go to <https://consultations.essex.gov.uk/infrastructure-delivery/consultation-for-great-bardfield-primary-school>

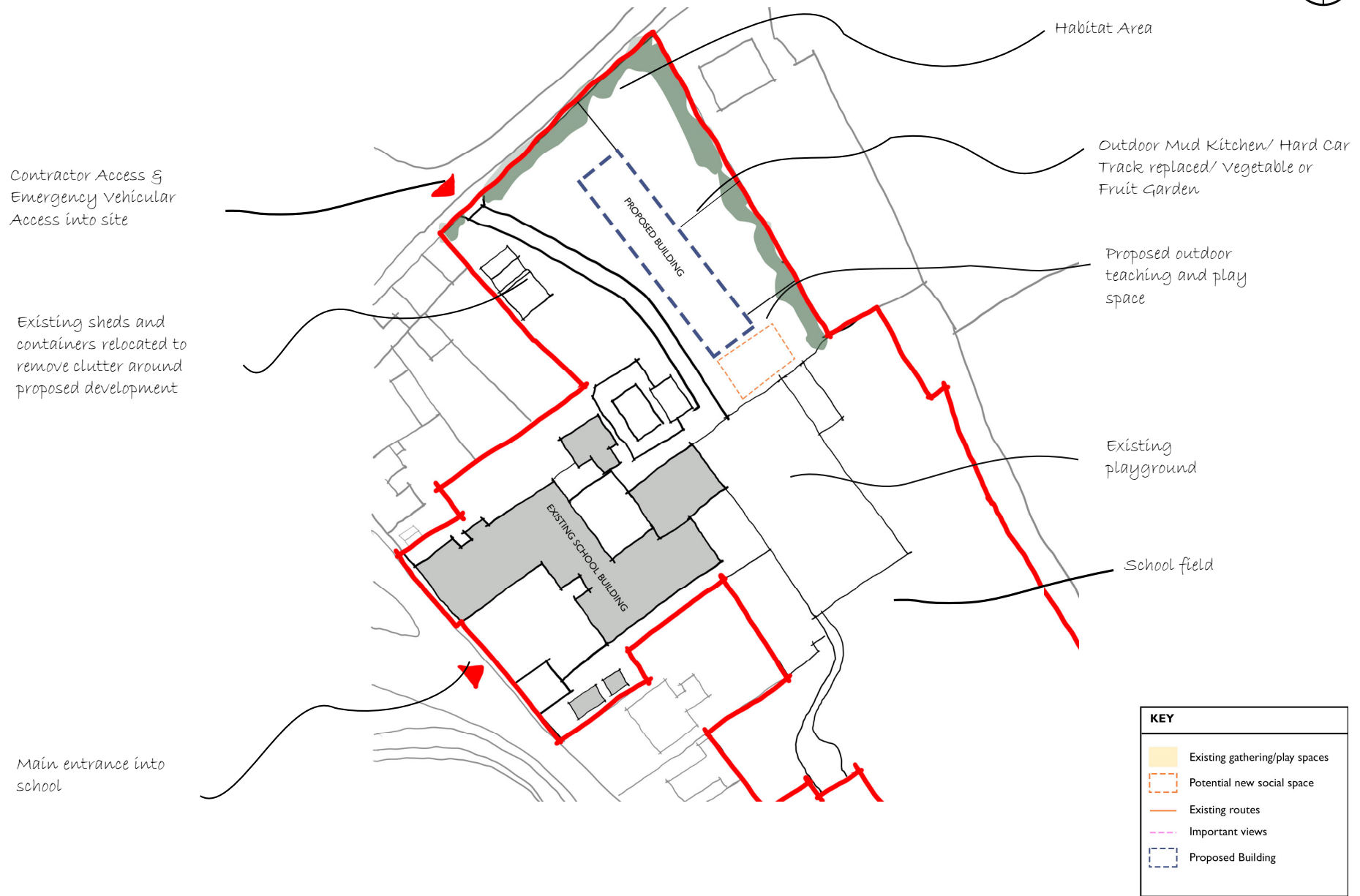

PROPOSED SITE PLAN

To comment on these proposals go to <https://consultations.essex.gov.uk/infrastructure-delivery/consultation-for-great-bardfield-primary-school>



## CONCEPT & DESIGN PROPOSALS

### Materials and Elevational Development

A simple and limited palette of materials is proposed for the new build which is mainly inspired by the site context and local vernacular as the site lies in a Conservation Area. A red brick building with flint panels is proposed to keep in line with the existing material palette of the existing Victorian School building and flint stones as apparent on other 'significant' buildings along Braintree Road. The objective is to tie the new building in with existing materials within the school.

The design principles break up the mass of the proposed block visually separating the cores and teaching spaces. The horizontality of the elevation is also expressed in the low level flint stone banding. Deep window frames, inspired by surrounding context will be used. A dark grey metal standing seam roof is proposed, to add a contemporary element to the traditional brick and flint.

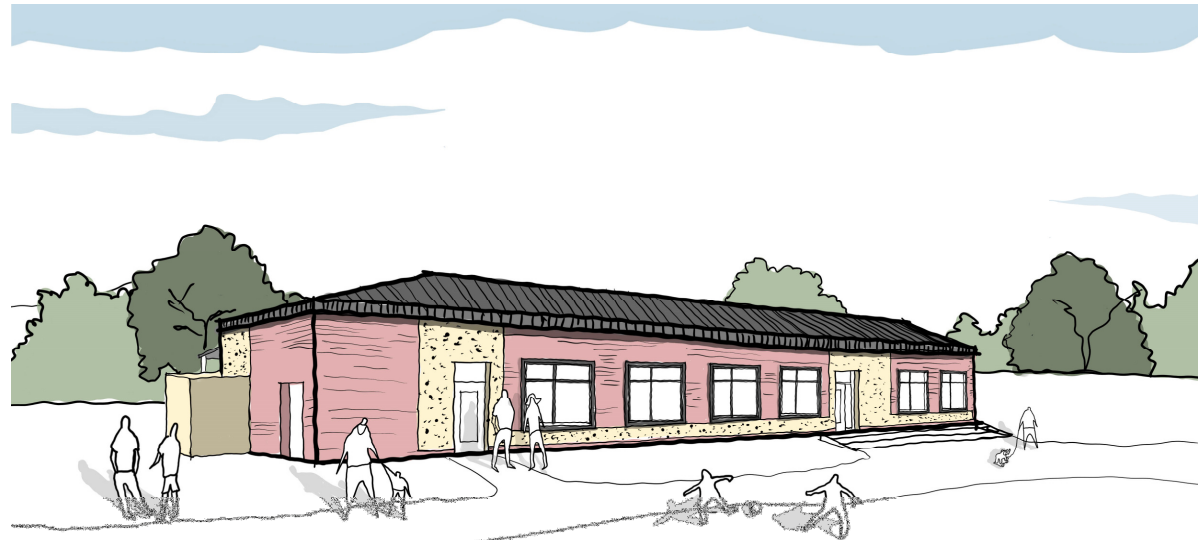

Proposed Perspective view from the North

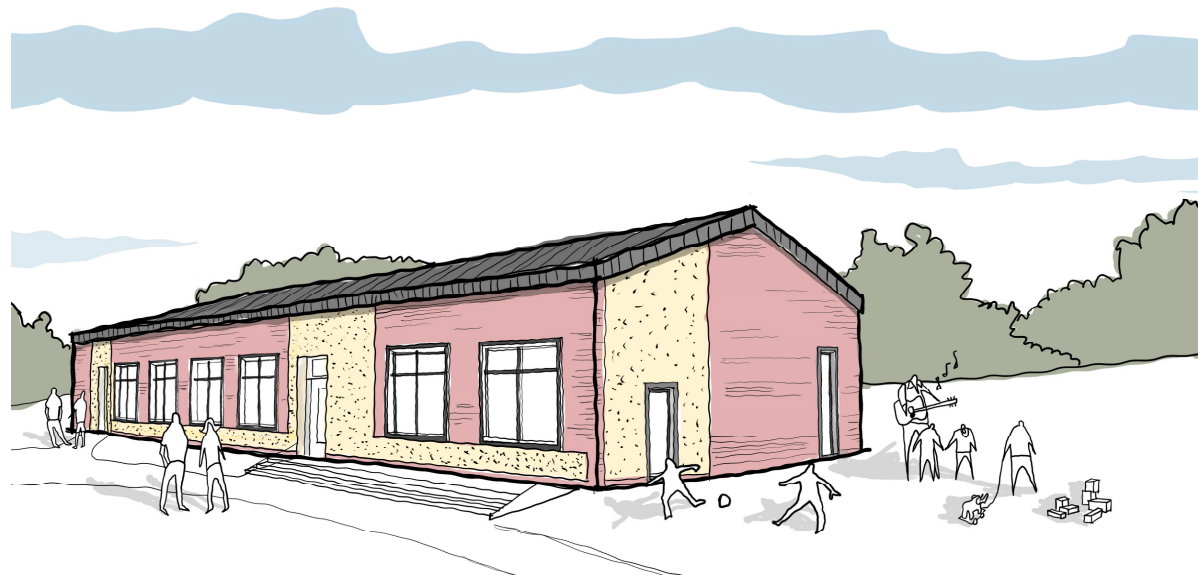

Proposed Perspective view from the South West

## PROPOSED ELEVATIONS & MATERIALS



## Have Your Say

To comment on these proposals go to <https://consultations.essex.gov.uk/infrastructure-delivery/consultation-for-great-bardfield-primary-school>

### Modular Construction

The proposed building will be of modular construction, a process by which a building is constructed off-site, under controlled factory conditions, using the same materials and designing to the same codes and standards, as conventional buildings – but can be constructed on site in about half the time. Buildings are produced in “modules” that when put together on site, reflect the identical design intent and specifications of highly sophisticated site-built facilities – without compromise. They can be built and arranged in any shape or style similar to a traditionally built building.

### Benefits

Some of the benefits of modular construction are listed below:

- Reduced time on site
- Fewer deliveries and construction vehicles
- Minimised disruption to the school

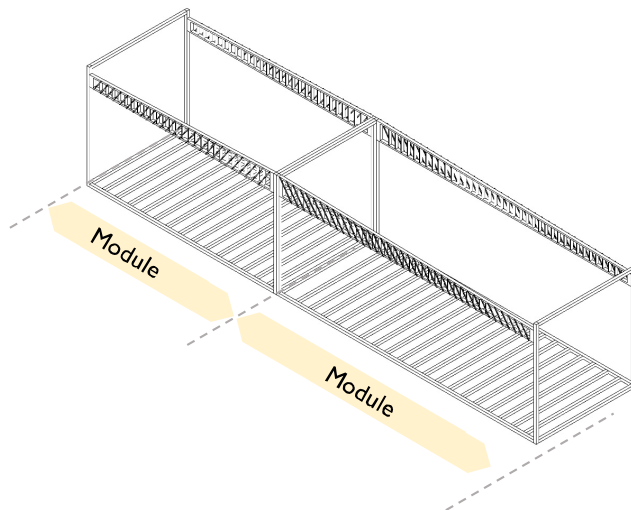

Typical structure of the modules



Site Plan showing Contractor access

CONSTRUCTION