

Dunmow St Marys Primary School

Proposed Improvement Works

Welcome to this public exhibition. Essex County Council and its team are pleased to present proposals for the new extension and temporary teaching block at Dunmow St Marys Primary School on High Stile.

This online exhibition is being held to inform the local residents about the emerging proposals and to give the opportunity to provide feedback. We value your input and feedback forms are available online for you to complete. We thank you for your interest.

Form Architecture are working with Mitie Group PLC to design and deliver the new school facilities and the proposals have been developed in close collaboration with the team at the School and Essex County Council.

This proposal comprises two elements; the installation of a temporary standalone classroom unit and the construction of a new extension to the existing school building to a new SEN (Special Educational Needs) group room. Due to the temporary increase in pupil numbers the school hall will be increased via demolition of existing sick bay and stores. These will be re-provided through a further extension at the back of school in close proximity to its current location.

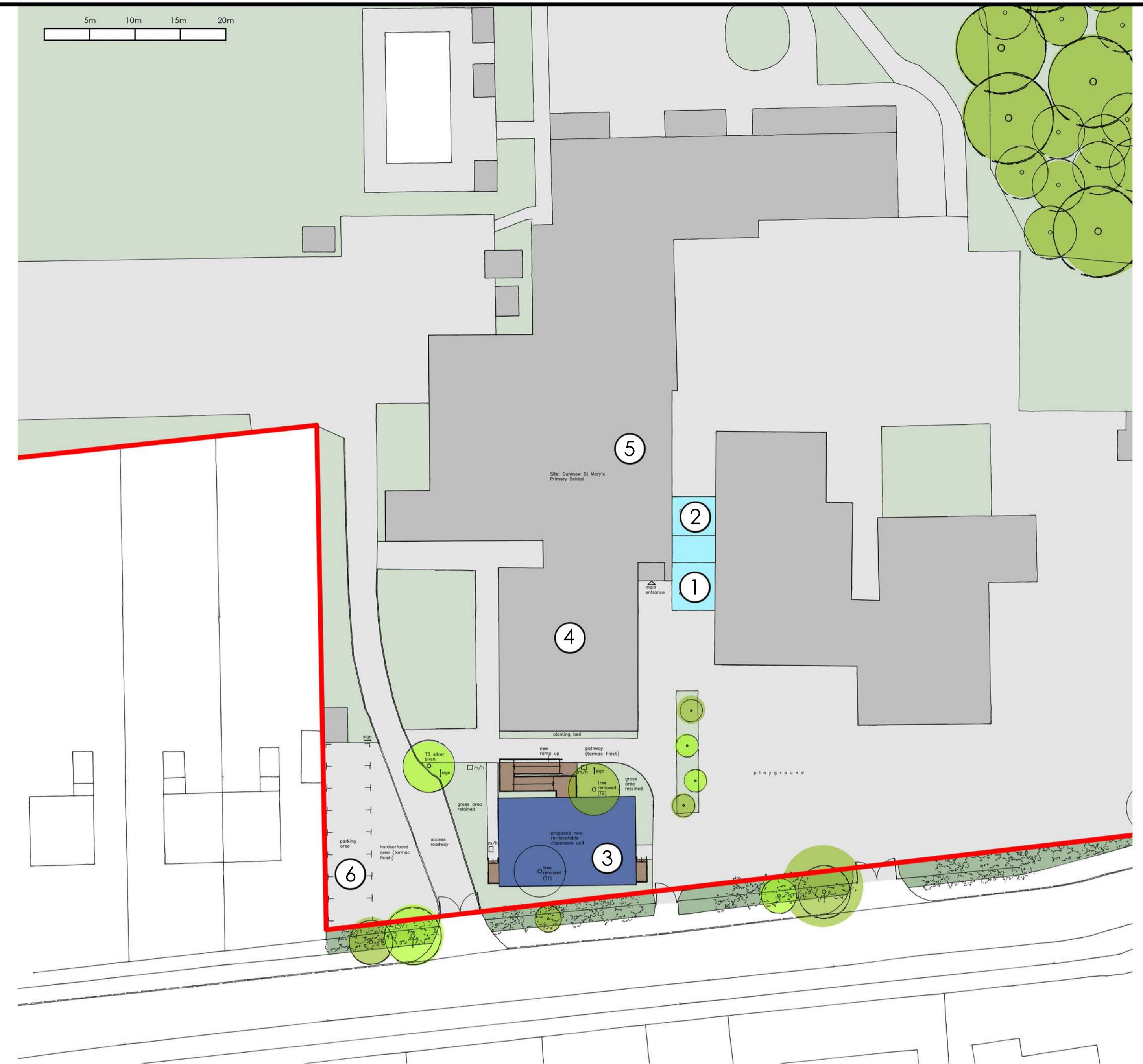

Key of Spaces

1. Proposed new SEN group room
2. Proposed First Aid Room
3. Proposed temporary relocatable classroom
4. Main school block
5. Main Hall (to be extended)
6. Car parking to front of the school

