

Essex County Council & Copford Church of England Voluntary Controlled Primary School

What

The Public Consultation is taking place to share proposed plans for replacing existing temporary classroom facilities at Copford Church of England Voluntary Controlled Primary School with the local community. It is your chance to review and comment upon the proposals before a planning application is submitted.

What's being done

The new teaching block at Copford Church of England Voluntary Controlled Primary School aims to create a modern energy efficient educational building on the existing school site which will replace existing relocatable classrooms which are now beyond their serviceable life.

The new building will provide 4 classrooms each with cloaks and stores, a new group room and new WC accommodation providing no loss of existing facilities.

The Project will be designed to deliver a low carbon energy footprint in Construction and in use. This will include renewable energy through roof mounted photovoltaic solar panels, highly efficient air source heat pumps generating heating and hot water; full fresh air through highly efficient mechanical heat recovery and efficient LED lighting which better represents natural daylighting. The building fabric will also be thermally enhanced. The new building will offer a more inclusive educational environment for the pupils.

Where is it?

The new building will be located in the heart of the school between the existing playground and sports field in the location of one of the temporary classrooms. By removing the 2 buildings to the south the hard outdoor play will be enhanced and connectivity across the school site improved as a whole.

When

The building will be finished and ready for occupation in December 2021. Work is planned to commence over the summer holidays. Two of the existing class room buildings containing 3 classrooms and on site will continue to provide accommodation during construction with an additional temporary classroom on the front playground. After the new building has been completed all 3 buildings and the temporary classroom will be removed.

Who is involved

The Project Partners are:

- Essex County Council
- Copford Church of England Voluntary Controlled Primary School

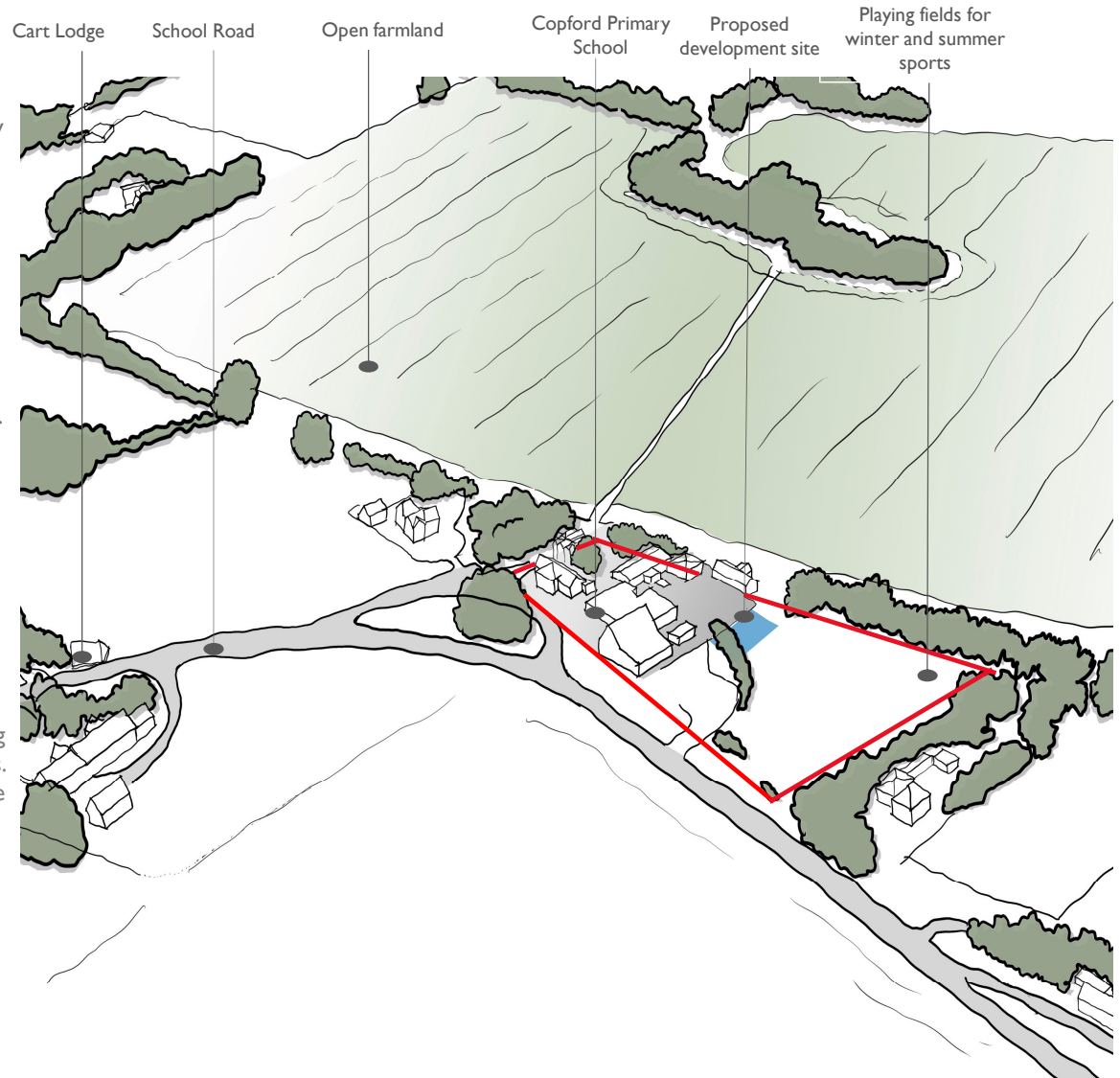

Have Your Say

To comment on these proposals go to: <https://consultations.essex.gov.uk/infrastructure-delivery/consultation-for-copford-primary-school>

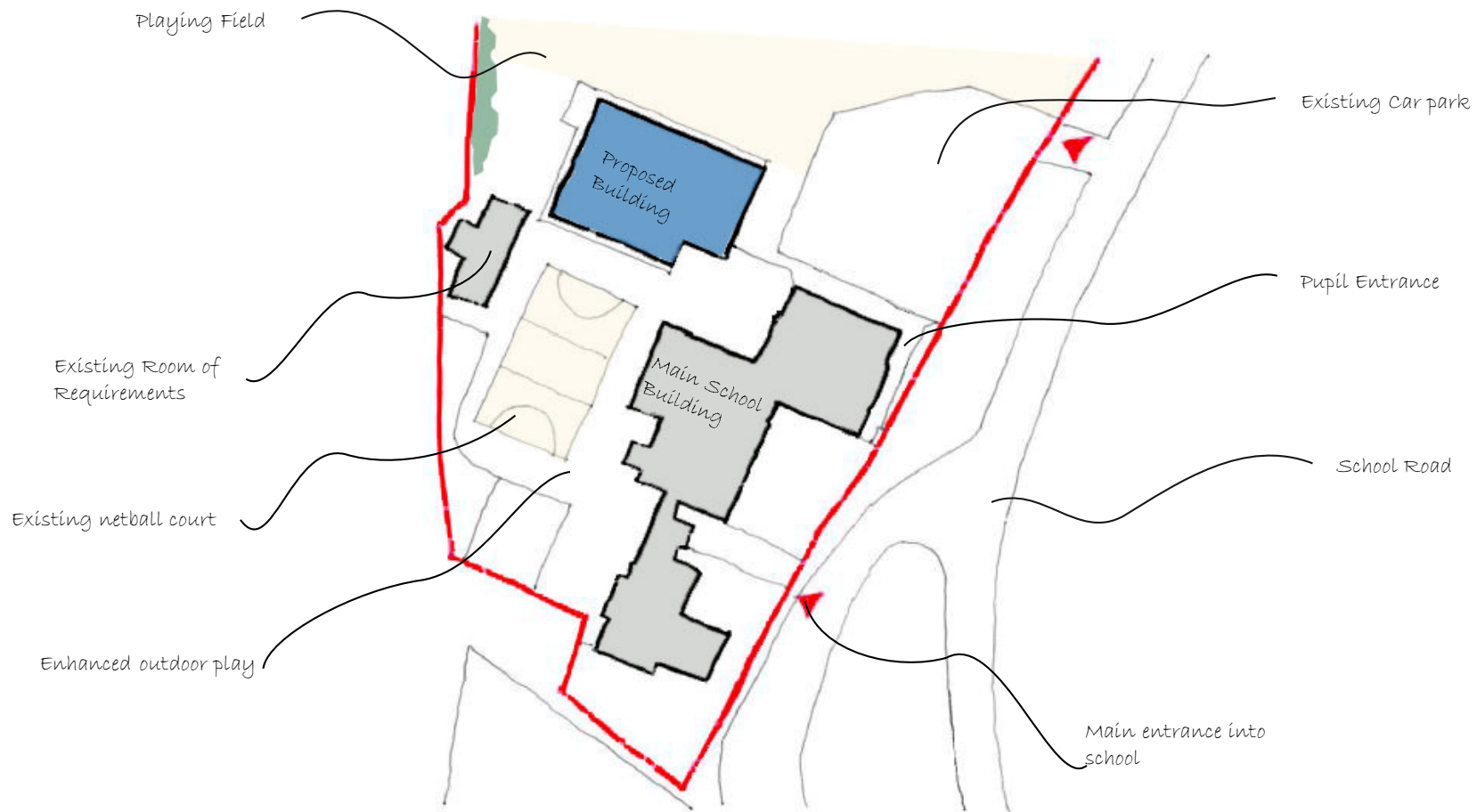

Have Your Say

To comment on these proposals go to: <https://consultations.essex.gov.uk/infrastructure-delivery/consultation-for-copford-primary-school>

Materials and Elevational Development

A simple palette of materials is proposed for the new build which aims to remain sensitive to the local context. The palette is limited to red brick, timber boarding and infill panelling to complement the cluster of existing buildings on site.

The red brick will create a visual connection with the Room of Requirements building on site and main school building. The timber weatherboarding is a local material used in the surrounding barns.

The main design principle for the elevational treatment is to break up the linear block through a play with solids and voids using glazing and false panelling to show direct relationship to internal functions.

Module lines within the building have been considered as indicative division lines to allow us to optimise maximum glazing. Classroom windows then become a void within the solid red brick cladding.

The roof facing the school playground and south will have photovoltaic panels providing renewable energy for the building. Air source heat pumps will be located on the west elevation generating heating and hot water for use in the building.



Have Your Say

To comment on these proposals go to: <https://consultations.essex.gov.uk/infrastructure-delivery/consultation-for-copford-primary-school>

Modular Construction

Modular construction is a process in which a building is constructed off-site, under controlled factory conditions, using the same materials and designing to the same codes and standards as conventional buildings— but in about half the time. Buildings are produced in “modules” that when put together on site, reflect the identical design intent and specifications of highly sophisticated site-built facilities – without compromise. They can be built and arranged in any shape or style similar to a traditionally built building.

Benefits

Some of the benefits of modular construction are listed below:

- Reduced time on site
- Few deliveries and construction vehicles
- Minimised disruption to the school

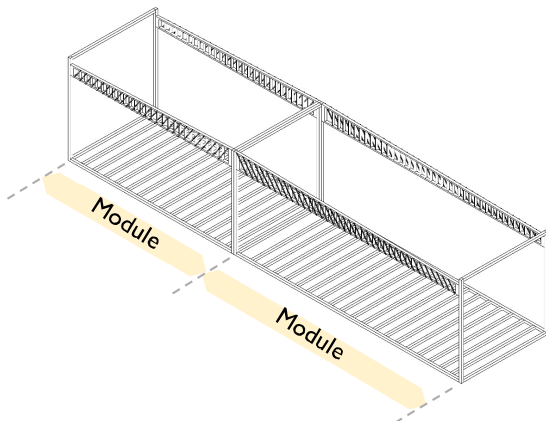

Typical structure of the modules

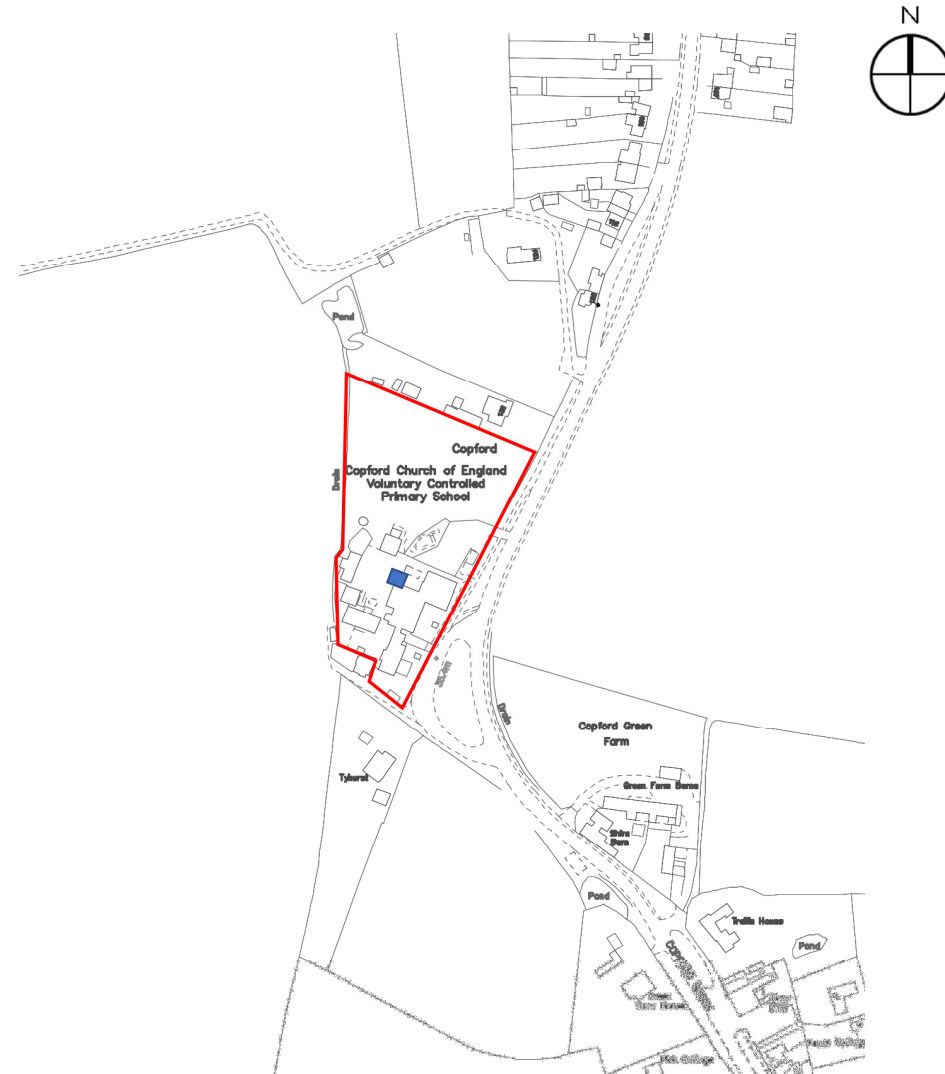

Have Your Say

To comment on these proposals go to: <https://consultations.essex.gov.uk/infrastructure-delivery/consultation-for-copford-primary-school>



Have Your Say

To comment on these proposals go to: <https://consultations.essex.gov.uk/infrastructure-delivery/consultation-for-copford-primary-school>



Have Your Say

To comment on these proposals go to: <https://consultations.essex.gov.uk/infrastructure-delivery/consultation-for-copford-primary-school>